

Soils Map

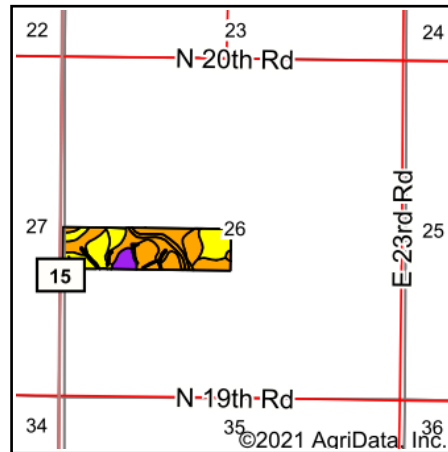
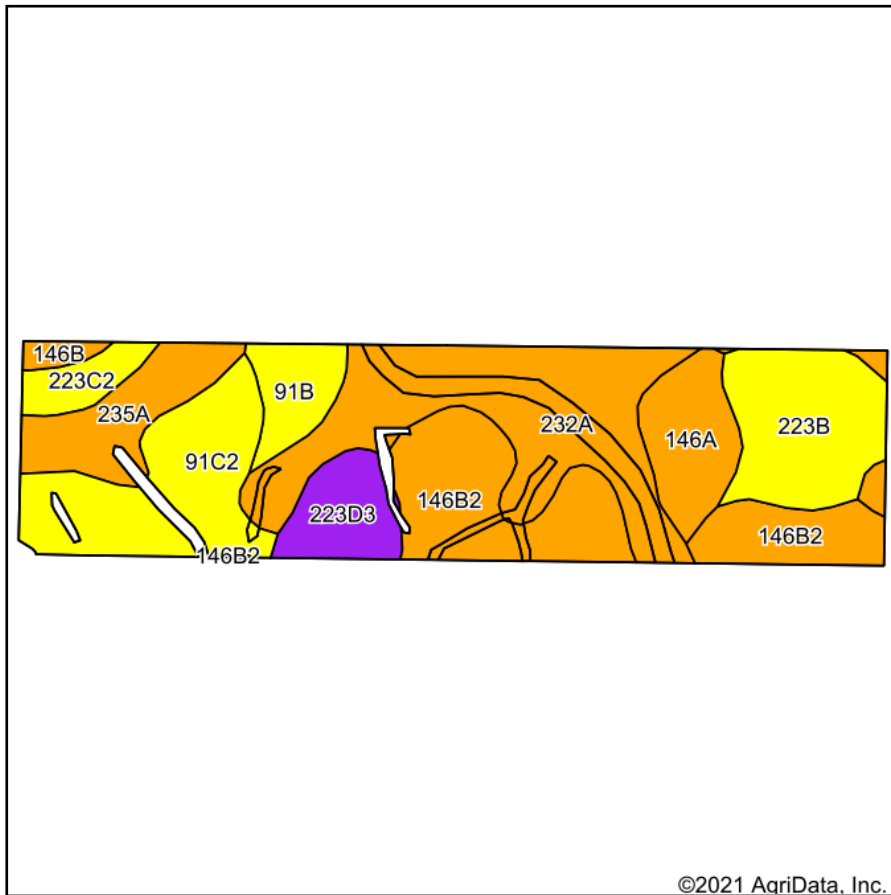

State: **Illinois**
 County: **La Salle**
 Location: **26-32N-4E**
 Township: **Grand Rapids**
 Acres: **38.54**
 Date: **2/3/2021**

Maps Provided By:

 CUSTOMIZED ONLINE MAPPING
 © AgriData, Inc. 2020 www.AgriDataInc.com



Soils data provided by USDA and NRCS.

Area Symbol: IL099. Soil Area Version: 16													
Code	Soil Description	Acres	Percent of field	Il. State Productivity Index Legend	Subsoil rooting a	Corn Bu/A	Soybeans Bu/A	Wheat Bu/A	Oats Bu/A	Sorghum c Bu/A	Alfalfa d hay, T/A	Grass-legume e hay, T/A	Crop productivity index for optimum management
232A	Ashkum silty clay loam, 0 to 2 percent slopes	9.54	24.8%		FAV	170	56	65	85	0	0.00	5.14	127
**146B2	Elliott silty clay loam, 2 to 4 percent slopes, eroded	7.43	19.3%		FAV	**160	**52	**65	**83	0	0.00	**4.77	**119
**91C2	Swygert silty clay loam, 4 to 6 percent slopes, eroded	5.62	14.6%		UNF	**147	**48	**59	**73	0	0.00	**4.20	**110
**223B	Varna silt loam, 2 to 4 percent slopes	4.77	12.4%		FAV	**156	**50	**63	**78	0	**4.84	0.00	**115
235A	Bryce silty clay, 0 to 2 percent slopes	2.92	7.6%		FAV	162	54	64	82	0	0.00	4.77	121
146A	Elliott silt loam, 0 to 2 percent slopes	2.80	7.3%		FAV	168	55	68	87	0	0.00	5.02	125
**223D3	Varna silty clay loam, 6 to 12 percent slopes, severely eroded	2.16	5.6%		FAV	**136	**43	**55	**68	0	**4.21	0.00	**100
**91B	Swygert silty clay loam, 2 to 4 percent slopes	1.72	4.5%		UNF	**156	**51	**62	**78	0	0.00	**4.47	**117
**223C2	Varna silt loam, 4 to 6 percent slopes, eroded	1.18	3.1%		FAV	**150	**48	**61	**75	0	**4.65	0.00	**110

**146B	Elliott silt loam, 2 to 4 percent slopes	0.40	1.0%		FAV	**166	**54	**67	**86	0	0.00	**4.97	**124
Weighted Average						159	51.9	63.2	80.4	*-	0.98	3.78	118.4

Table: Optimum Crop Productivity Ratings for Illinois Soil by K.R. Olson and J.M. Lang, Office of Research, ACES, University of Illinois at Champaign-Urbana. Version: 1/2/2012 Amended Table S2 B811

Crop yields and productivity indices for optimum management (B811) are maintained at the following NRES web site: <http://soilproductivity.nres.illinois.edu/>

** Indexes adjusted for slope and erosion according to Bulletin 811 Table S3

a UNF = unfavorable; FAV = favorable

b Soils in the southern region were not rated for oats and are shown with a zero "0".

c Soils in the northern region or in both regions were not rated for grain sorghum and are shown with a zero "0".

d Soils in the poorly drained group were not rated for alfalfa and are shown with a zero "0".

e Soils in the well drained group were not rated for grass-legume and are shown with a zero "0".

*c: Using Capabilities Class Dominant Condition Aggregation Method

Soils data provided by USDA and NRCS. Soils data provided by University of Illinois at Champaign-Urbana.